

Zone 2B & 2C (Contract No.: CC/2020/2B/088)

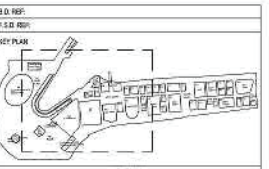

- NOTES**
- WKCD BOUNDARY
 - M+ MUSEUM BOUNDARY
 - LYRIC THEATRE BOUNDARY
 - BOUNDARY OF UNDERPASS ROAD SERVING THE PLANNED WKCD
 - X CONSTRUCTION AIR/NOISE MONITORING STATION

REMARKS:
 THE AIR MONITORING STATION AM2A HAS BEEN RELOCATED TO THE ALTERNATIVE MONITORING STATION AM2B AT 1ST FLOOR OF GAMMON'S SITE OFFICE ON 26 FEBRUARY 2019.

- Zone 2A Boundary
- Zone 2B & 2C Boundary
- Under Management by Zone 2B & 2C Contractor Starting from 20 Dec 2022
- No Construction Work and Only Maintenance Work is Carried Out by Zone 2B & 2C Contractor Starting from 01 April 2023

REV.	DATE	DESCRIPTION	INITIAL

JOB TITLE DEVELOPMENT AT WEST KOWLOON CULTURAL DISTRICT

DRAWING TITLE SITE LAYOUT PLAN AND MONITORING STATIONS

SCALE	1:50	PRINTED	A1
CHECKED:		DATE	
APPROVED:		DATE	
DRAWN	TY	DATE	15-10-2015
CONTRACT NO:			

DRAWING NO.	REV.
FIGURE 1	XA

CAD REF NAME: XXXXX\AUT\PLNS\DWG PROJ\000-0000-0000.dwg

AUTHORITY

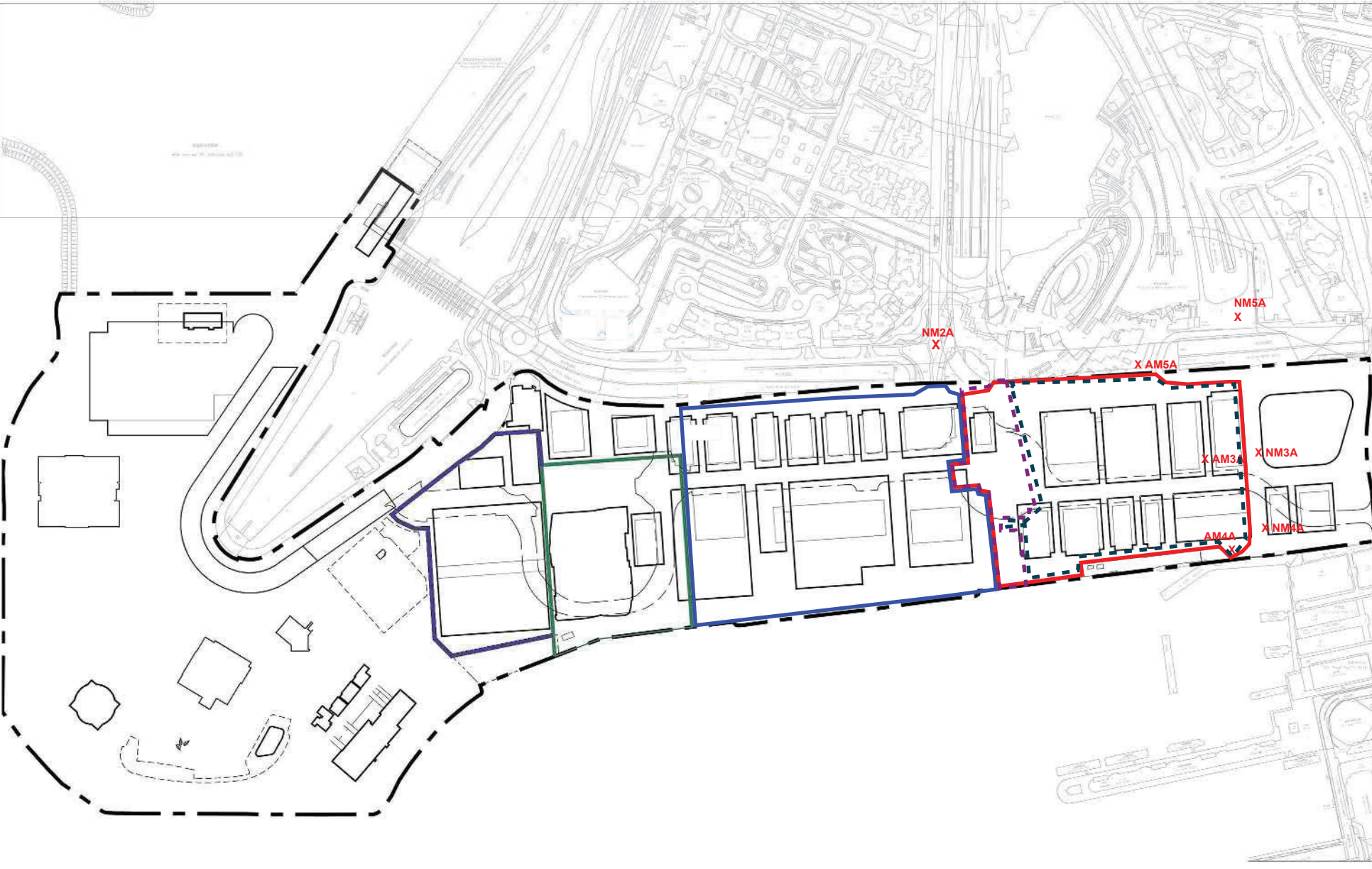

Zones 2A, 2B & 2C (Contract No.: CC/2023/2B/095)

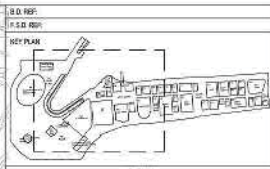

- NOTES**
- WKCD BOUNDARY
 - M+ MUSEUM BOUNDARY
 - LYRIC THEATRE BOUNDARY
 - - - BOUNDARY OF UNDERPASS ROAD SERVING THE PLANNED WKCD
 - X CONSTRUCTION AIR/NOISE MONITORING STATION

REMARKS:
 THE AIR MONITORING STATION AM2A HAS BEEN RELOCATED TO THE ALTERNATIVE MONITORING STATION AM2B AT 1ST FLOOR OF GAMMON'S SITE OFFICE ON 26 FEBRUARY 2019.

Zones 2A, 2B & 2C
 Boundary (Contract No.: CC/2023/2B/095)

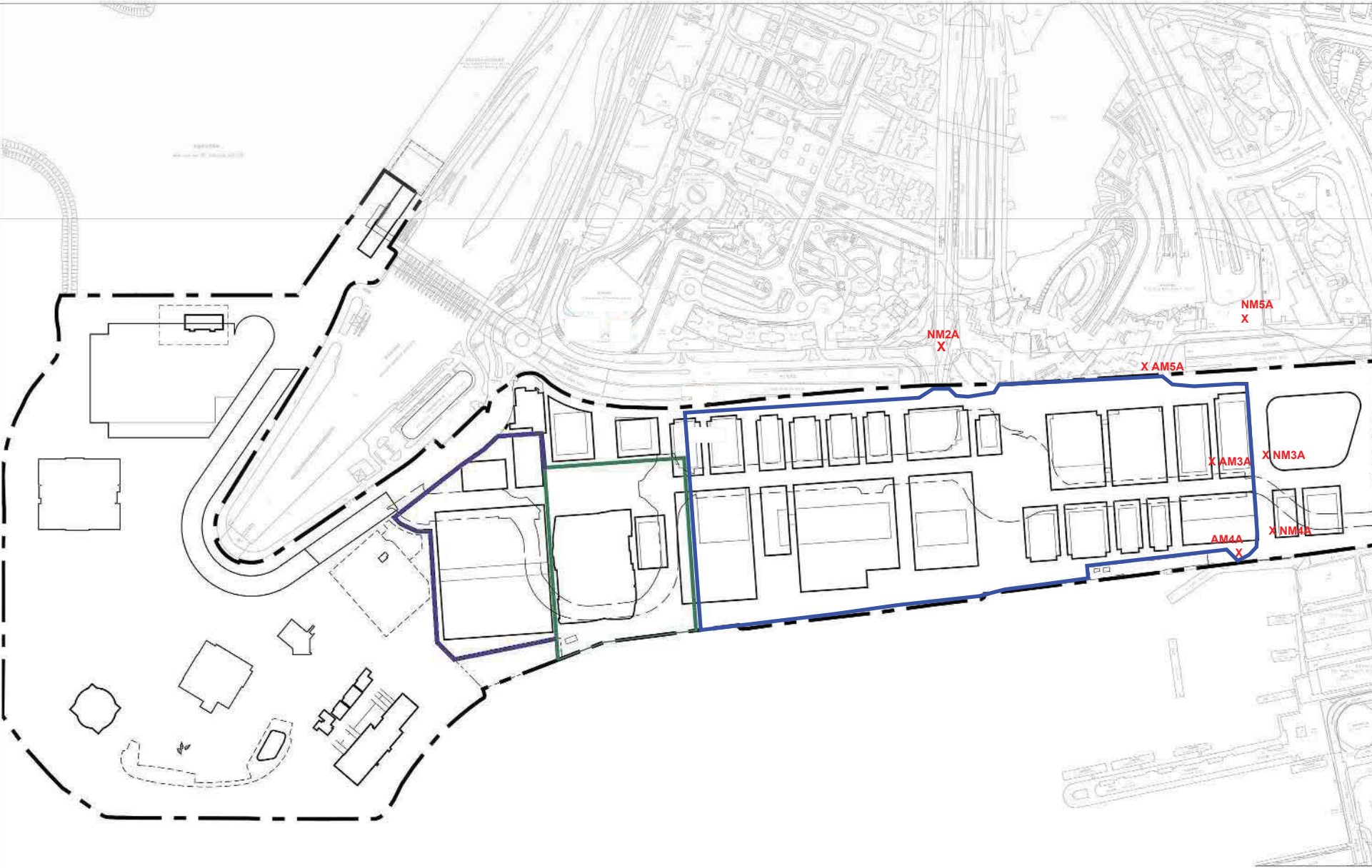

REV.	DATE	DESCRIPTION	INITIAL

J2B 11111 **DEVELOPMENT AT WEST KOWLOON CULTURAL DISTRICT**

DRAWING TITLE **SITE LAYOUT PLAN AND MONITORING STATIONS**

SCALE	1:50	PRINTED	A1
CHECKED:		DATE	
APPROVED:		DATE	
DRAWN	TY	DATE	15-05-2019

CONTRACT NO. -

DRAWING NO. **FIGURE 1** REV. **XX**

CAD REF NAME: X0000_A1T_PNS_DWG_PROJ_080-0000-000.dwg

AUTHORITY

westKowloon
 西九文化區