

| Zoning of the Surrounding Areas of the WKCD Site  |  |
|---|--|
| <b>Commercial (C)</b>                             |  |
| C 1   | China Hong Kong City, Hong Kong Hotel and Prince Hotel The Macro Polo Hong Kong Hotel, Harbour City and Ocean Centre, The Gateway, |
| C 2   | Commercial Developments Located west of Kowloon Park Drive, East of Canton Road and North of Peking Road                           |
| <b>Residential (R)</b>                            |  |
| R1 and R2   | Planned residential development above Austin Station   |
| R3  | Wai On Building & Wai Hang Building  |
| R4  | Victoria Tower   |
| <b>Comprehensive Development Area (CDA)</b>       |  |
| CDA 1   | International Commerce Centre, the Elements, the Harbourside, the Arch, the Waterfront, Sorrento Towers & the Cullinan.            |
| CDA 2   | West Kowloon Terminus  |
| <b>Open Space (O)</b>                             |  |
| O 1   | King George V Memorial Park, Kowloon   |
| O 2   | Kowloon Park   |
| O 3   | Resting Area Fronting Kowloon Park Drive   |
| <b>Other Specific Use (OU)</b>                    |  |
| OU 1  | Public cargo working area  |
| OU 2  | West Harbour Crossing Toll Plaza   |
| OU3   | Hong Kong China Ferry Terminal   |
| OU4   | Pacific Club   |
| OU5   | Pumping Station  |
| OU6   | Ocean Terminal   |
| <b>Government, Institution or Community (GIC)</b> |  |
| GIC 1   | GIC Facility   |
| GIC 2   | Kwun Chung Municipal Services Building   |
| GIC 3   | Lai Chack Middle School  |
| GIC 4   | Canton Road Government Primary School  |
| GIC 5   | Hong Kong Scout Centre & International House   |
| GIC 6   | Yau Tsim District Police Headquarters and Tsim Sha Tsui police station, Kowloon Park Sports Centre and Kowloon Park Swimming Pool  |
| GIC 7   | Kowloon Mosque & Islamic Centre  |

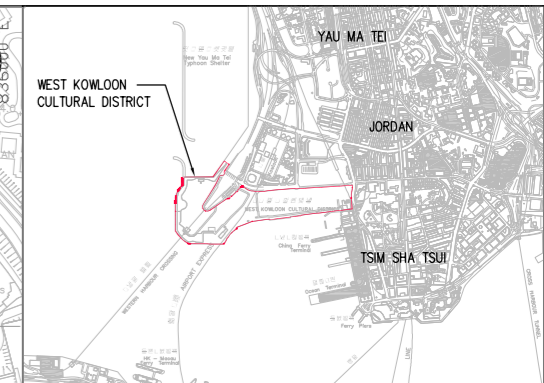
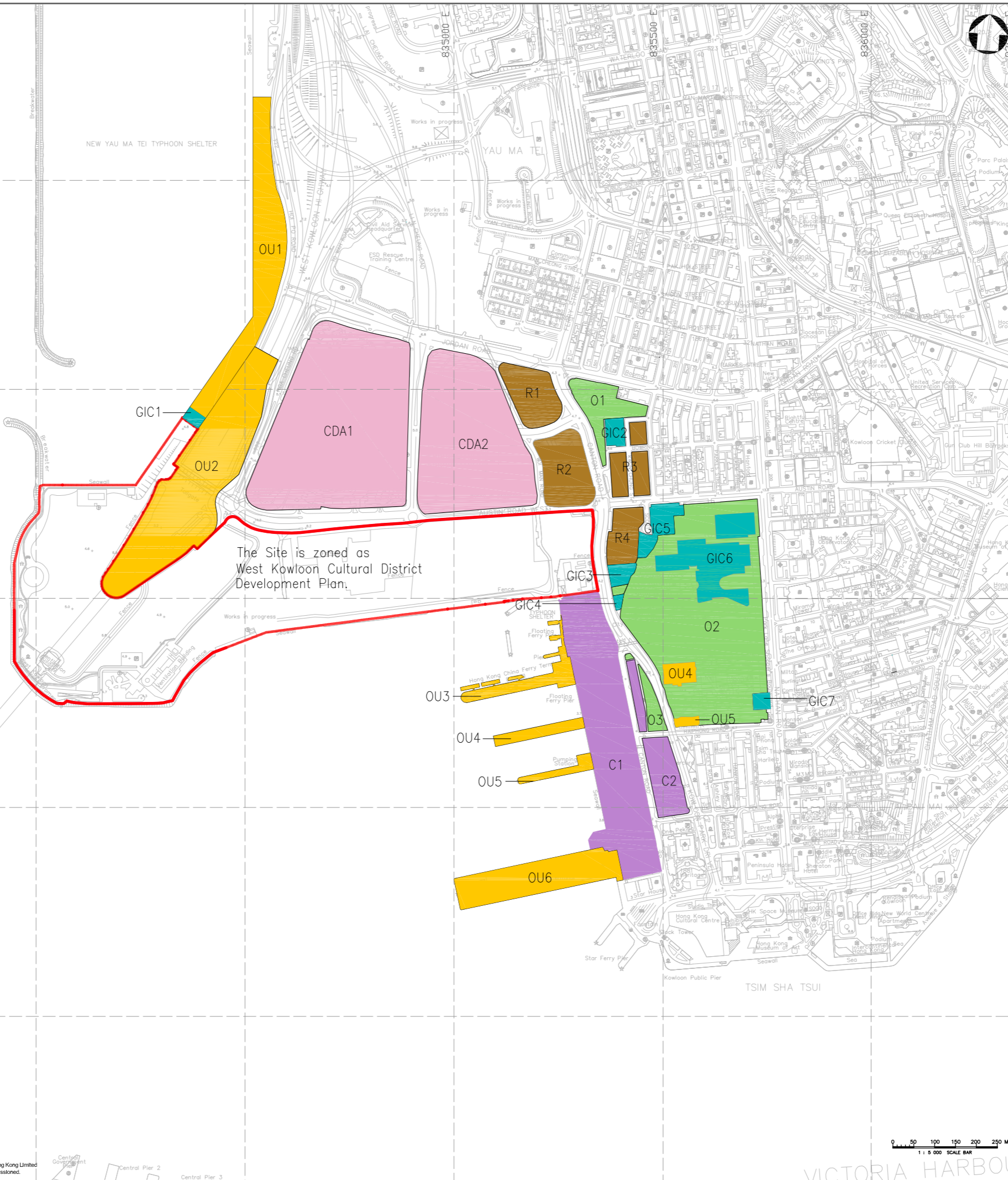

**LEGEND**

- Comprehensive Development Area (CDA)
- Government, Institution or Community (GIC)
- Commercial (C)
- Residential (Group A) (R (A))
- Open Space (O)
- Other Specified Uses (OU)
- Site Boundary

| Rev | Date | Drawn | Description | Ch'k'd | App'd |
|-----|------|-------|-------------|--------|-------|
|     |      |       |             |        |       |

Client  
**WEST KOWLOON CULTURAL DISTRICT AUTHORITY**

**Mott MacDonald**

22/F Two Landmark East  
100 How Ming Street  
Kwun Tong, Kowloon  
Hong Kong  
T +852 2828 6167  
F +852 2827 1829  
W www.mottmac.com.hk

**ARTEC** **IMG Artists** **Lord**

**TFP | FARRELLS** **G | H | K**

**creative thinking positive solutions** **earthaxis limited**

**DONNELL**

**LD ASIA** **BMT**

Project  
**PROJECT CONSULTANCY STUDY FOR WEST KOWLOON CULTURAL DISTRICT DEVELOPMENT PLAN**

Title  
**ZONING OF THE SITE AND SURROUNDING AREAS**

|                        |        |              |     |
|------------------------|--------|--------------|-----|
| Designed               | CC     | Eng check    |     |
| Drawn                  | CC     | Coordination |     |
| Dwg check              | PC     | Approved     | PL  |
| Scale at A1<br>1: 5000 | Status |              | Rev |

Drawing Number  
**Figure 10.6**