

Separation Distance: 15m  
 Total Number of  
 Small and Big Wind Turbines: 38



Big Wind Turbines  
 Total Height: 15m  
 Total Number: 13

Small Wind Turbines  
 Total Height: 12m  
 Total Number: 25

817000 N

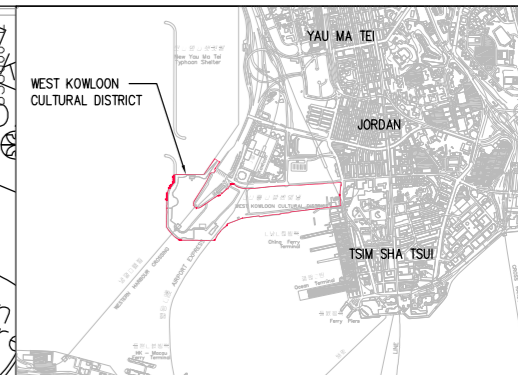
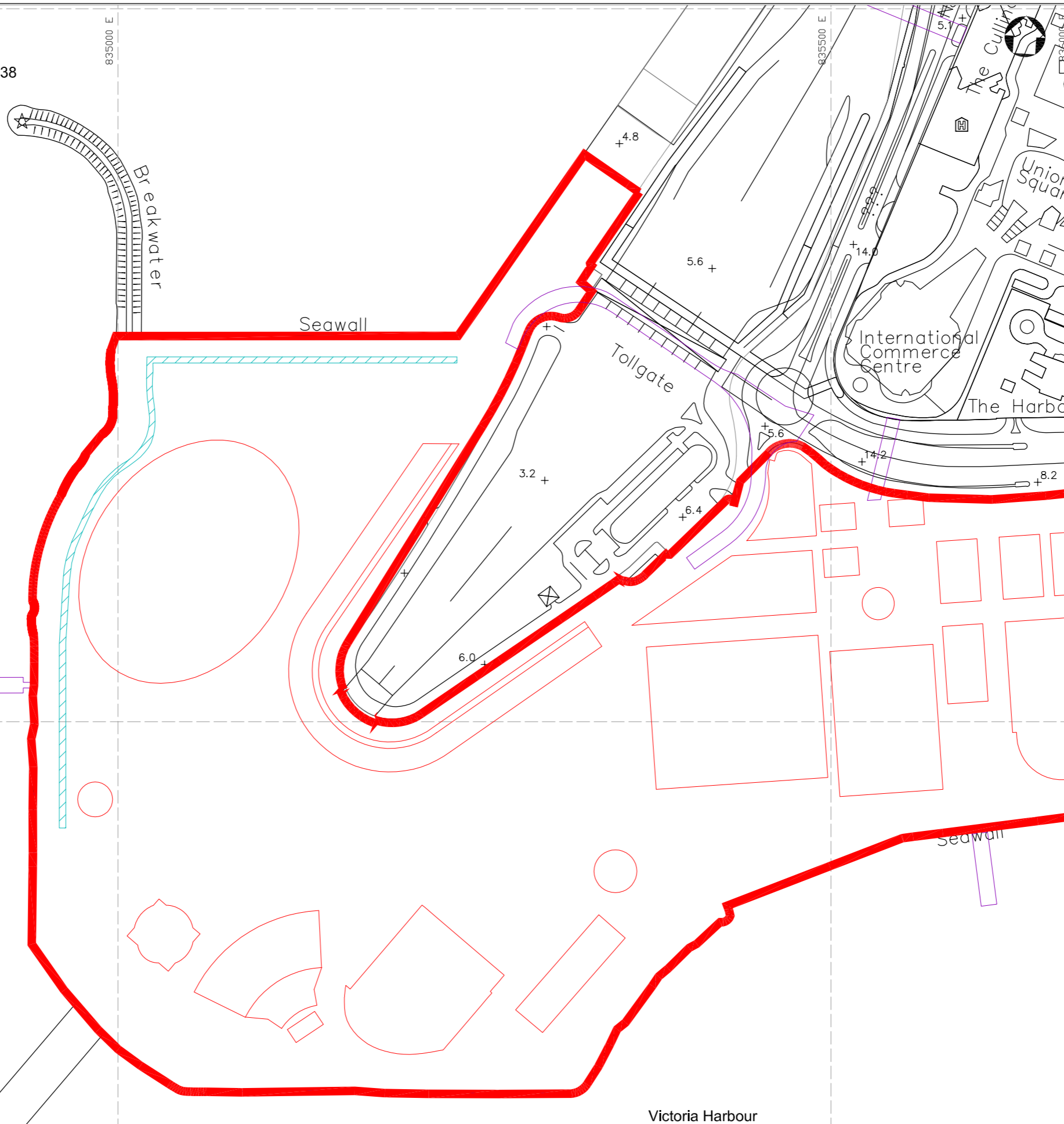

KEY PLAN

LEGEND

- Location of the Proposed Wind Turbines
- Site Boundary

Rev	Date	Drawn	Description	Ch'k'd	App'd

Client  
**WEST KOWLOON  
 CULTURAL DISTRICT AUTHORITY**



20/F Two Landmark East,  
 100 How Ming Street,  
 Kowloon, Hong Kong  
 T +852 2828 6767  
 F +852 2877 1873  
 W www.mottmac.com.hk



Project  
**PROJECT CONSULTANCY STUDY FOR  
 WEST KOWLOON CULTURAL DISTRICT  
 DEVELOPMENT PLAN**

Title  
**LOCATION OF  
 PROPOSED WIND TURBINES**

Designed	CC	Eng check	
Drawn	CC	Coordination	
Dwg check	PC	Approved	PL
Scale at A1 1: 150	Status	Rev	

Drawing Number  
**Figure 10.24**